

### Beli Chan

Sales Manager

M: +86 139 2586 8276

WhatsApp: +86 139 2586 8276

E-mail: Beli@championbagmaker.com

MACHINERY MANUFACTURER OF **LUXURY PAPER BAGS**

CHAMPION MACHINERY MANUFACTURING CO.,LTD.

Add: 42#2and Longyan Industrial Avenue, Humen Town Dongguan City, China PR  
Website: www.paper-bag-machine.com

**CHAMPION**  
MACHINERY



### Coffee Gong

Sales

M: +86 186 8118 5198

WhatsApp: +86 134 2327 5528

E-mail: sales8@championbagmaker.com

MACHINERY MANUFACTURER OF **LUXURY PAPER BAGS**

CHAMPION MACHINERY MANUFACTURING CO.,LTD.

Add: 42#2and Longyan Industrial Avenue, Humen Town Dongguan City, China PR  
Website: www.paper-bag-machine.com

**CHAMPION**  
MACHINERY

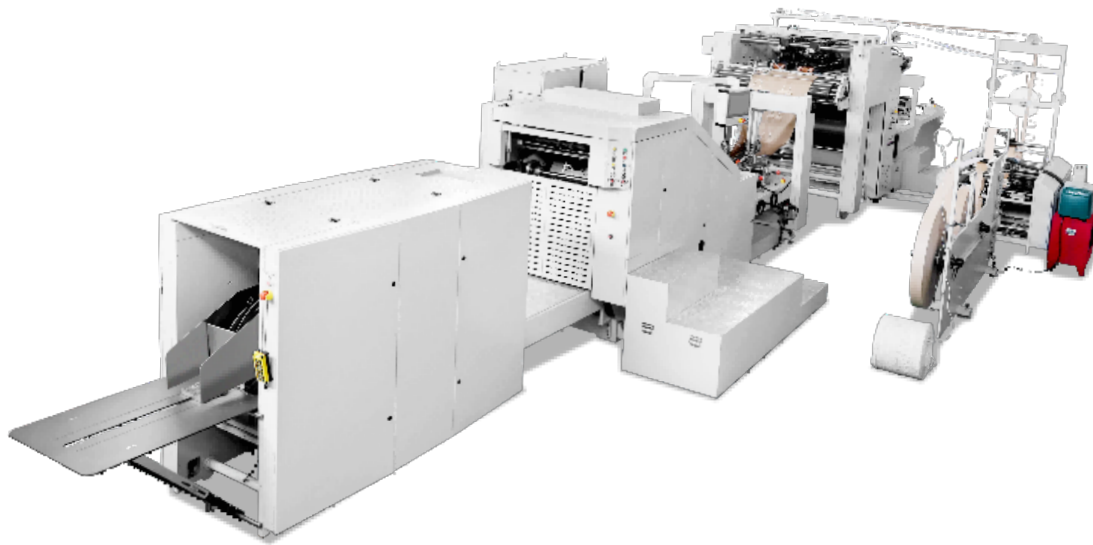

## CM-330T

Automatic Shopping Paper Bag Machine  
With Twisted Rope Handle Inline

卷筒纸袋机（带扭绳手柄）

## 目录

### Contents

机器名称图片 Machine Name Image	3
工艺流程图 Process Flowchart	3
机器说明 Machine Description	4
机器特点 Machine Features	4
性能及用途 Properties	4
主要技术参数 TechnicalData	5
设备占地规划 Machine Floor Plan	6

# CM-330T

Automatic shopping paper bag machine with  
Twisted rope handle inline

卷筒纸袋机

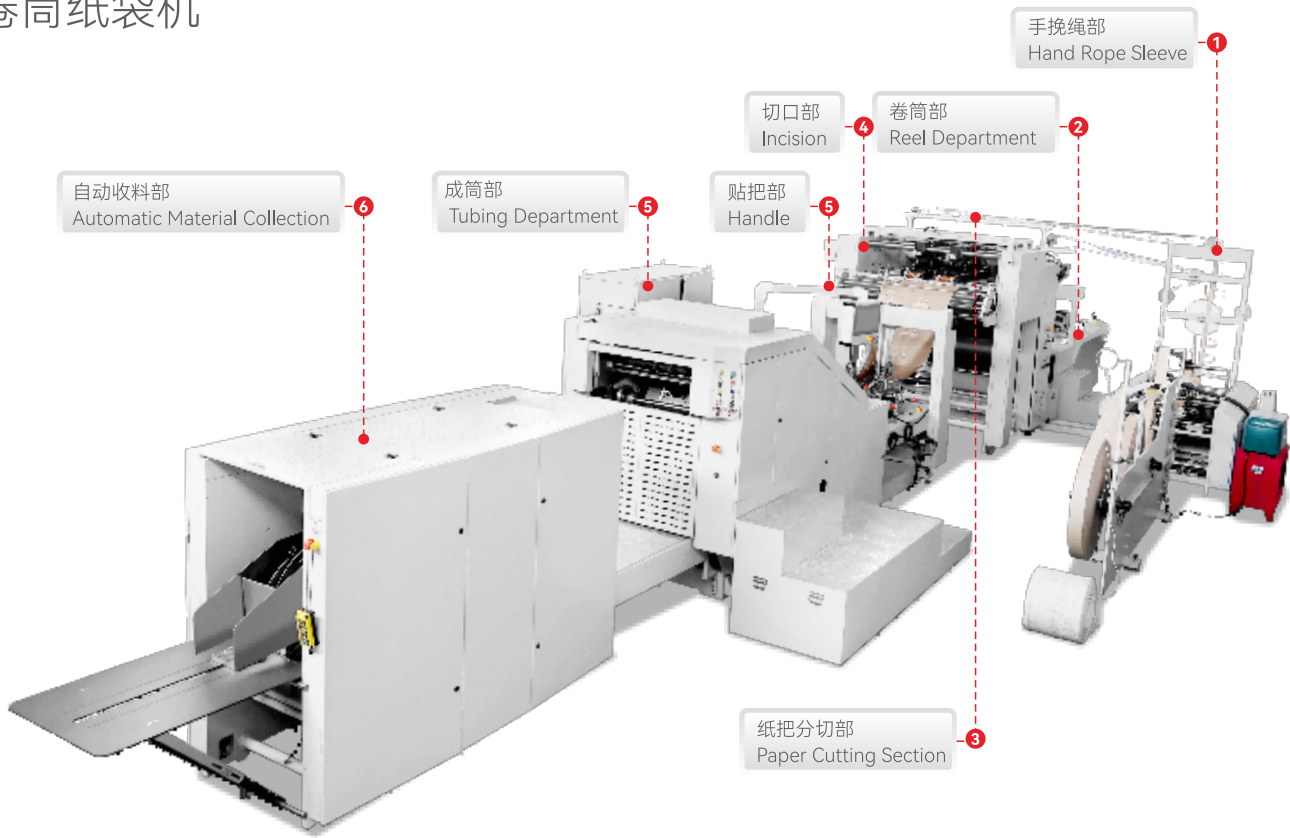

## 工艺流程图 Process Flowchart

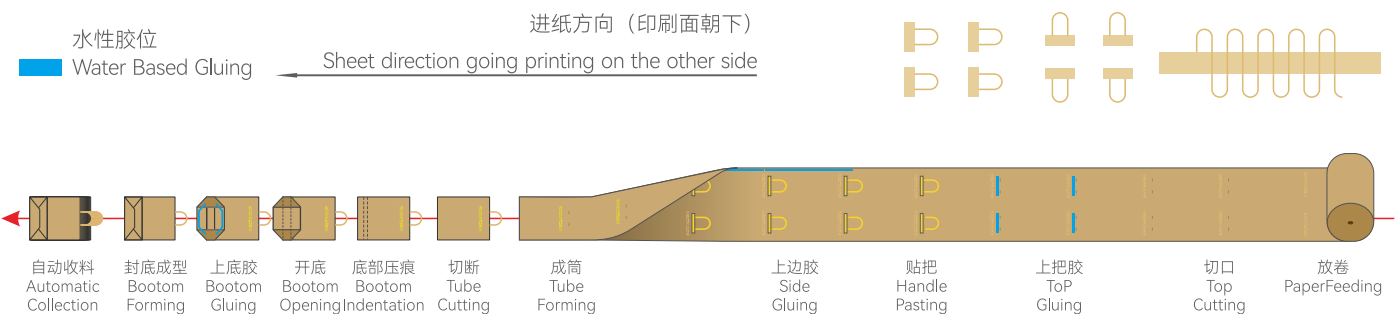



## 机器说明 Machine Description

卷筒式方底纸袋机，采用卷筒空白纸或印刷好的纸卷为原料，由自动中心进胶、印刷跟踪、定长切断、底部压痕、折底、底部涂胶、袋底成型、成品袋收集一次性完成，该机更方便、更高效、更稳定，可生产各种不同规格的纸袋，休闲食品袋、面包袋、干果袋等环保型纸袋机设备。

Rolling feed square bottom paper bag making machine, it uses paper roll in blank or printed as raw material. consists of automatic centre forward glue, printing tracking, fixed length and cutting, bottom indentation, folding bottom, bottom glue. Bag bottom forming, finished bag collecting one time. The machine is more convenient, more efficient, more stable, can produce a variety of different paper bags, leisure food bags, bread bags, dried fruit bags and so on environmentally friendly paper bag machine equipment.



## 机器特点 Machine Features

1. 采用法国施耐德触摸屏人机界面，操作便捷，控制方便。
2. 采用德国原装LENZE PC控制器，集成光纤，确保高速稳定运行。
3. 采用德国原装LENZE伺服电机和德国原装SICK光电眼纠偏，精准跟踪印刷袋。
4. 原料上料采用液压上下料结构，放卷采用自动张力控制。
5. 采用机械可调式成型板，操作简便。

1. Use France Schneider Touch Screen Human-Computer Interface, operate and control easily.
2. Adopt Germany Original LENZE PC Control, integrated with optical fiber, ensure high speed running steadily.
3. Germany Original LENZE Servo Motor and Germany Original SICK Photoelectric Eye Correction, tracking printing bag accurately.
4. Raw material load adopt Hydraulic pressure up and down structure, unwinding adopt auto tension control.
5. Use mechanical adjustable forming plate for easy operation.



## 性质与用途 Properties And Uses

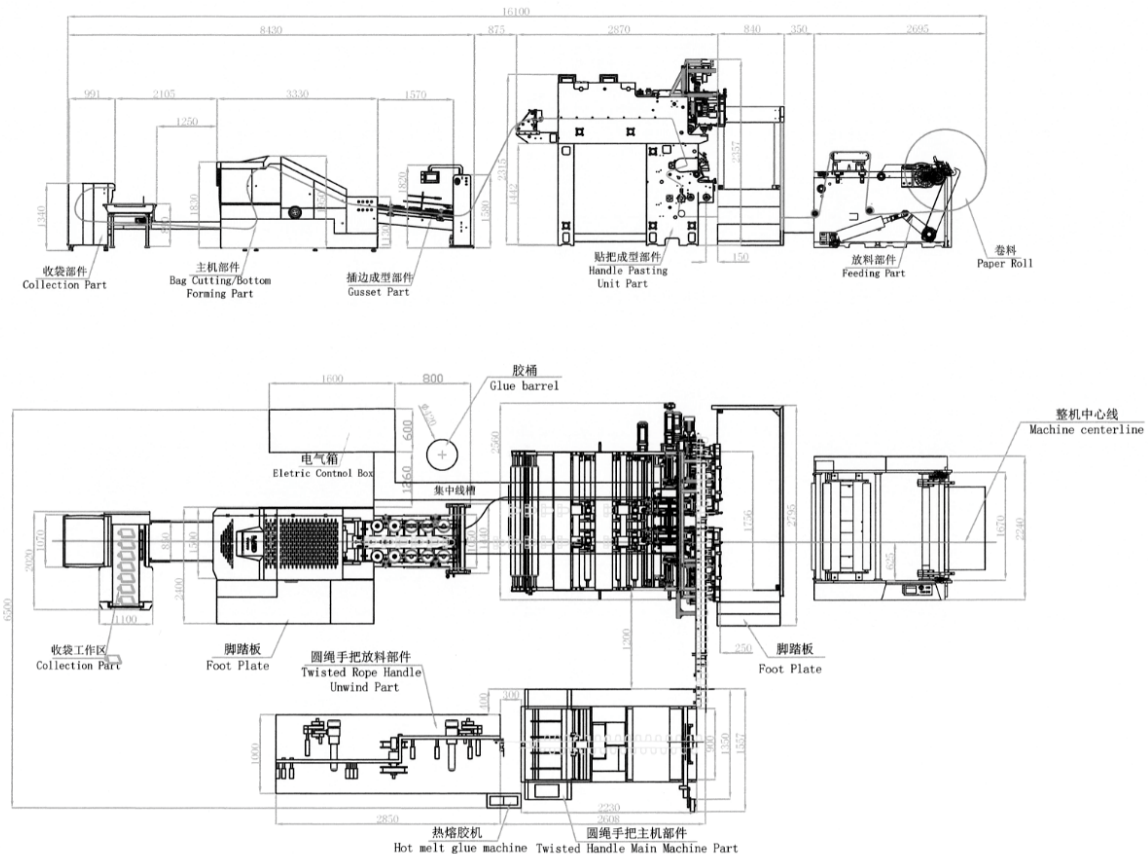



## 主要技术参数 Technical Data

### 纸袋部分 Paper bag part

切割长度	Cutting length	270-530mm	270-430mm (Handle)
袋宽	Bag width	120-330mm	200-330mm (Handle)
底宽	Bottom width	70-180mm	80-140g/m <sup>2</sup> (Handle)
纸卷最大宽度	Paper roll Maximum width	1050mm	
卷纸直径	Roll paper diameter	φ1200mm	
纸管	Paper core	φ76mm	

### 绳柄部分 Rope handle part

手柄纸张长度	Patch length		152mm
手柄纸张宽度	Patch width		45-50mm
手柄绳高度	Handle rope height		100mm
手柄距离	Handle distance		75mm
绳子直径	Rope diameter		φ3-5mm
手柄纸张纸卷宽度	Patch paper roll width		90-100mm
手柄纸张纸卷直径	Patch paper roll diameter		φ1000mm
手柄纸张纸厚度	Patch paper thickness		80-130g/m <sup>2</sup>

### 规格 Specification

机器速度	Machine Speed		30-200bags/min
无把手袋生产速度	production speed for bags without handles		30-180bags/min
带把手袋生产速度	production speed for bags with handles		30-140bags/min
切刀	Cutting knife		Teeth cutting
电源	Power Supply		380V 3Phase 40 KW
机器重量	Machine weight		13.5T
机器尺寸	Machine size		15000x6000x2700mm

底部折叠方式

Bottom folding type

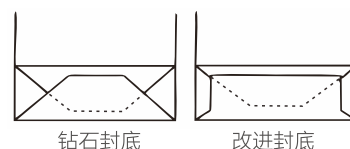

钻石封底

改进封底



设备占地规划 Machine Floor Plan

